

STAINLESS STEEL BEAM CLAMP

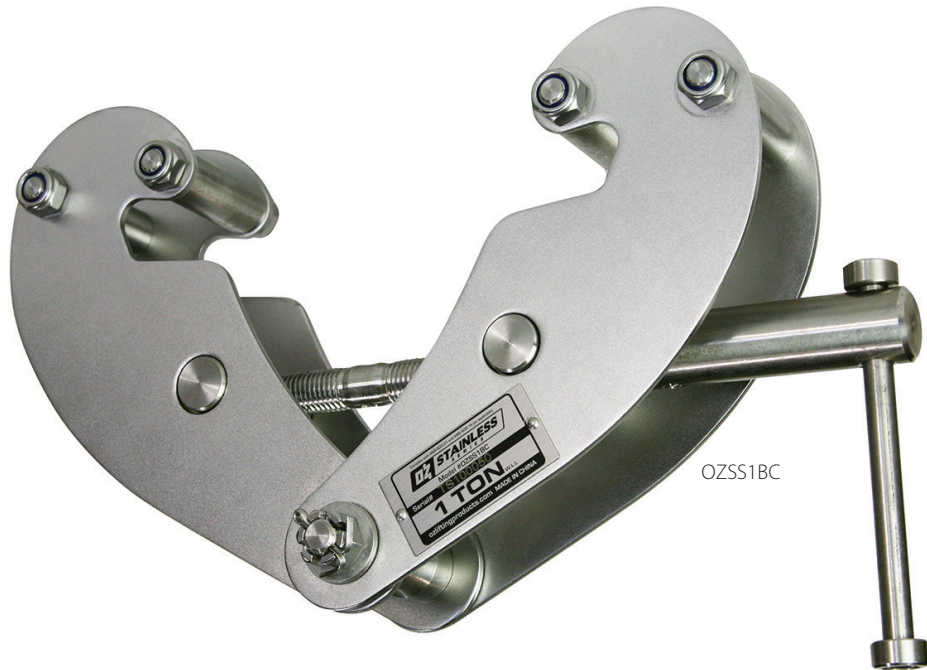

Features

- Stainless Steel Type 304 Construction for Corrosion Resistance
- Super-Quick Adjustment to most I-Beams
- Stainless Steel I.D. Tag
- Individual Test Certificate and Serial Number

Standards - CE, AS4991, ASME B30.10 (For use with manual or powered hoists)

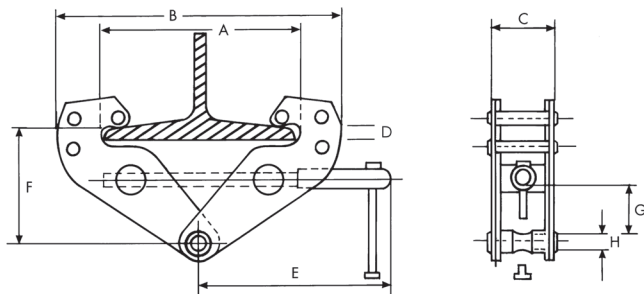

	OZSS1BC	OZSS2BC
Safe Working Load (lbs)	2,000	4,000
A	2.95-9.05	2.95-9.05
B	12.2 max.	12.2 max.
C	2.6	3
Dimensions (in)	D .94	.94
	E 7.68	7.68
	F 5.12-6.57	5.12-6.57
	G 1.57	1.57
	H .78	.9
Net Weight (lbs)	9	11

